

Mishima

Design D+P david+pulvirentistudio



Semplicità e pulizia di linee per questo sistema di contenitori nati dall'idea di offrire la più ampia varietà di composizioni con il minimo numero di componenti. Tre gli elementi base del sistema: contenitore Alto, contenitore Basso e Top. Due le altezze con un'unica profondità e un'unica larghezza per i contenitori, che possono essere attrezzati con cassetti, cassettoni o ante e liberamente accostati o sovrapposti. Il Top è l'elemento aggregante e decorativo che creando un gioco di volumi vuoto/pieno dà carattere alle composizioni e ne enfatizza la funzione. Le finiture sono disponibili nelle principali essenze e in una vasta gamma di colori laccati opachi o lucidi, tutti combinabili tra loro, per dare totale libertà compositiva. Un sistema che soddisfa la crescente esigenza di personalizzazione dell'abitare contemporaneo.

Finiture

Laccato Opaco

51 Giallo zinco / 53 Arancio puro / 54 Rosso pomodoro / 27 Rosso rubino / 56 Lilla rosato / 58 Turchese pastello / 50 Bianco segnale / 19 Bianco puro / 23 Grigio alluminio / 60 Grigio antracite / 28 Marrone grigio / 24 Nero intenso

Laccato Lucido (Consegna 60 gg)

15 Giallo zinco / 52 Arancio puro / 26 Rosso pomodoro / 16 Rosso rubino / 55 Lilla rosato / 57 Turchese pastello / 49 Bianco segnale / 14 Bianco puro / 59 Grigio alluminio / 17 Grigio antracite / 61 Marrone grigio / 18 Nero intenso

Legno (solo per contenitori)

01 Rovere naturale / 03 Rovere tinto Bianco / 04 Rovere Naufragio / 05 Rovere tinto Grigio scuro / 06 Rovere tinto Wengè / 07 Rovere Moro / 62 Noce / 12 Ebano / 13 Ebano Bianco-Nero

This minimalist and streamlined configuration of containers and surfaces is beautiful in its simplicity: a small number of components can be rearranged to produce a surprising variety of shapes. The components include a High container, a Low container and a Top. The containers, of uniform depth and width but not height, can be fitted with drawers or doors. The containers can be shuffled, stacked and superimposed. The Top/raised surface, decorative as well as functional, unifies and characterizes the configuration. The finishings, available in the main wood essences and in a big range of mat or high gloss lacquered colours, can be mixed and matched to create highly personalized configurations.

Finishings

Matt Lacquered

51 zinc Yellow / 53 pure Orange / 54 tomato Red / 27 ruby Red / 56 red Lilac / 58 pastel Turquoise / 50 signal White / 19 pure White / 23 aluminium Grey / 60 anthracite Grey / 28 grey Brown / 24 jet Black

Glossy Lacquered (Delivery 60 days)

15 zinc Yellow / 52 pure Orange / 26 tomato Red / 16 ruby Red / 55 red Lilac / 57 pastel Turquoise / 49 signal White / 14 pure White / 59 aluminium Grey / 17 anthracite Grey / 61 grey Brown / 18 jet Black

Wood (only for containers)

01 Natural oak / 03 White stained oak / 04 "Naufragio" oak / 05 Dark Grey stained oak / 06 Wengè stained oak / 07 Dark Brown oak / 62 Walnut / 12 Ebony / 13 White-Black Ebony



Realizzabile su richiesta Laccato Opaco o Lucido in tutti i colori RAL con supplemento del 7% sui relativi prezzi

Available upon request in Matt or Highgloss Lacquer finish in all RAL colours with extra 7% on correspondent prices

Contenitore Basso

Low Container

MSH003

L 90 P 55 H 24 cm

Con cassetto

L 35 3/8" W 21 5/8" H 9 4/8"

With drawer

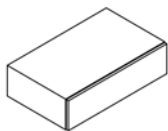

MSH004

L 90 P 55 H 24 cm

Con anta a ribalta

L 35 3/8" W 21 5/8" H 9 4/8"

With flap door

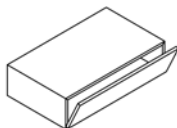

Contenitore Alto

High Container

MSH001

L 90 P 55 H 40 cm

Con cassettone

L 35 3/8" W 21 5/8" H 15 6/8"

With big drawer

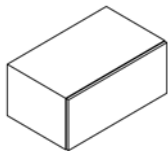

MSH002

L 90 P 55 H 40 cm

Con anta a ribalta

L 35 3/8" W 21 5/8" H 15 6/8"

With flap door

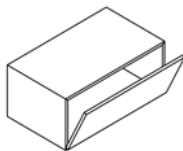

Porta CD/DVD

Barra porta CD o DVD in Alluminio anodizzato Naturale per contenitori con cassetto.

CD/DVD Holder

Natural anodized Aluminium CD/DVD-holder bar for containers with drawer.

MSH2000

L 79 P 20 H 5 cm

Può contenere fino a 60 CD o 40 DVD

L 31 1/8" W 7 7/8" H 2"

It stores up to 60 CD or 40 DVD

Top per 2 elementi Solo laccato lucido o opaco

Top for 2 elements Only highgloss or matt lacquered

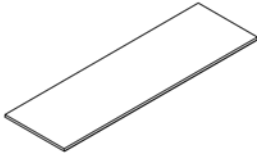

MSH061

L 180 P 55 H 2 cm

Top basso doppio

L 70 7/8" W 21 5/8" H 6/8"

Top double low

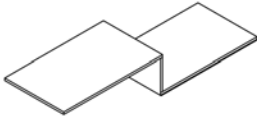

MSH062

L 180 P 55 H 13,5 cm

Top con sopralzo 1 alto singolo + 1 basso singolo

L 70 7/8" W 21 5/8" H 5 3/8"

Top with compartment 1 single high + 1 single low

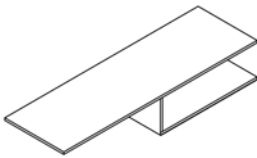

MSH063

L 180 P 55 H 13,5/27,5 cm

Top con sopralzo 1 alto doppio + 1 basso singolo

L 70 7/8" W 21 5/8" H 5 3/8"-10 7/8"

Top with compartment 1 double high + 1 single low

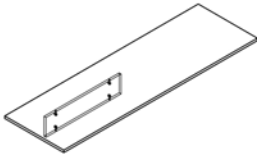

MSH065

L 180 P 55 H 13,5 cm

Top con sopralzo 1 alto doppio

L 70 7/8" W 21 5/8" H 5 3/8"

Top with compartment 1 double high

Composizioni a 2 elementi

I prezzi delle composizioni in legno sono calcolati con top in laccato opaco

Compositions with 2 elements

Prices for wood compositions includes matt-lacquered top

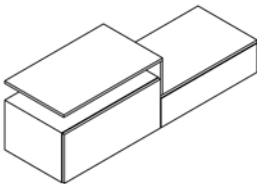

MSH121

L 180 P 55 H 26/55,5 cm

1 contenitore basso con anta a ribalta + 1 alto con cassettone + top MSH062

L 70 7/8" W 21 5/8" H 10 2/8" - 21 7/8"

1 low container with flap door + 1 high with big drawer + top MSH062

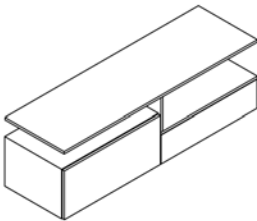

MSH122

L 180 P 55 H 55,5 cm

1 contenitore basso con anta a ribalta + 1 alto con cassettone + top MSH063

L 70 7/8" W 21 5/8" H 21 7/8"

1 low container with flap door + 1 high with big drawer + top MSH063

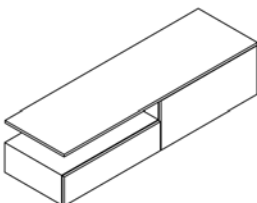

MSH124

L 180 P 55 H 42 cm

1 contenitore basso con anta a ribalta + 1 alto con cassettone + top MSH065

L 70 7/8" W 21 5/8" H 16 4/8"

1 low container with flap door + 1 high with big drawer + top MSH065

Foro passacavi

Eseguibile su contenitori e top

Cable management cut

Available on containers and top

Supplemento per foro

Supplement per cut

Top per 3 elementi Solo laccato lucido o opaco

Top for 3 elements Only highgloss or matt lacquered

MSH051

L 270 P 55 H 2 cm

top basso triplo

L 106 2/8" W 21 5/8" H 6/8"

top triple low

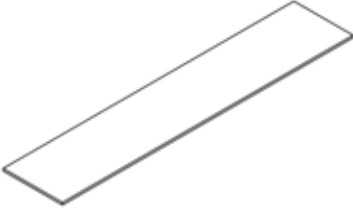

MSH052

L 270 P 55 H 13,5 cm

top con sopralzo 1 alto singolo + 1 basso doppio

L 106 2/8" W 21 5/8" H 5 3/8"

Top with compartment 1 single high + 1 double low

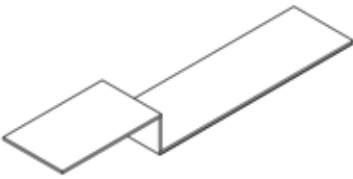

MSH053

L 270 P 55 H 13,5/27,5 cm

top con sopralzo 1 alto doppio + 1 basso doppio

L 106 2/8" W 21 5/8" H 5 3/8" - 10 7/8"

Top with compartment 1 double high + 1 double low

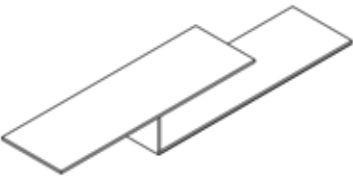

MSH054

L 270 P 53-55 H 13,5/27,5 cm

top con sopralzo 1 alto triplo + 1 basso singolo

L 106 2/8" W 20 7/8"-21 5/8" H 5 3/8" - 10 7/8"

Top with compartment 1 triple high + 1 single low

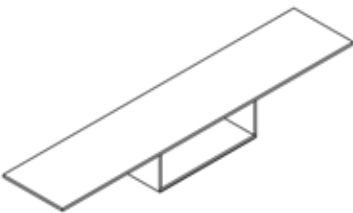

MSH055

L 270 P 55 H 16 cm

top con sopralzo 1 alto triplo

L 106 2/8" W 21 5/8" H 6 2/8"

Top with compartment 1 triple high

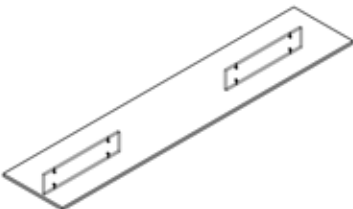

Composizioni a 3 elementi

I prezzi delle composizioni in legno sono calcolati con top in laccato opaco

Compositions with 3 elements

Prices for wood compositions includes matt-lacquered top

MSH101

L 270 P 55 H 26/55,5 cm

1 contenitore alto con cassettone + 1 basso con anta a ribalta + 1 basso con cassetto + top MSH052

L 106 2/8" W 21 5/8" H 10 2/8"- 21 7/8"

1 high container with big drawer + 1 low with flap door + 1 low with drawer + 1 top MSH052

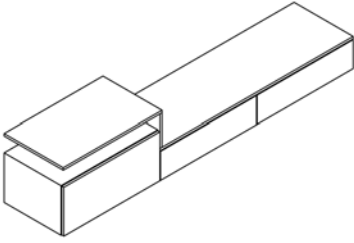

MSH102

L 270 P 55 H 26/55,5 cm

1 contenitore alto con cassettone + 1 basso con anta a ribalta + 1 basso con cassetto + top MSH053

L 106 2/8" W 21 5/8" H 10 2/8"- 21 7/8"

1 high container with big drawer + 1 low with flap door + 1 low with drawer + 1 top MSH053

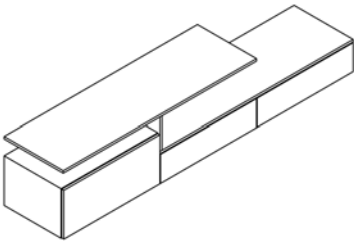

MSH103

L 270 P 53-55 H 55,5 cm

2 contenitori alti con cassettone + 1 basso con cassetto + top MSH054

L 106 2/8" W 20 7/8"-21 5/8" H 21 7/8"

2 high containers with big drawer + 1 low with drawer + 1 top MSH054

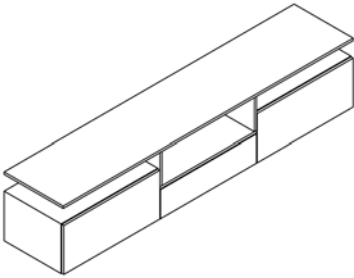

MSH104

L 270 P 55 H 42 cm

1 contenitore basso con cassetto + 1 basso con anta a ribalta + 1 alto con cassettone + top MSH055

L 106 2/8" W 21 5/8" H 16 4/8"

1 low container with drawer + 1 low with flap door + 1 high with big drawer + 1 top MSH055

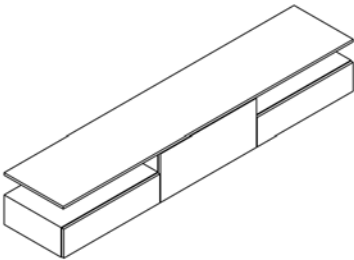

Foro passacavi

Eseguibile su contenitori e top

Cable management cut

Available on containers and tops

Supplemento per foro

Supplement per cut

Misure utili interne

Useful internal measures



MSH124



MSH104

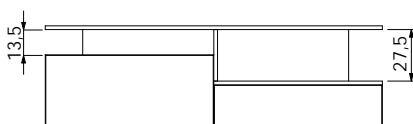
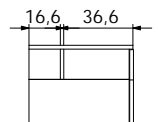

MSH122

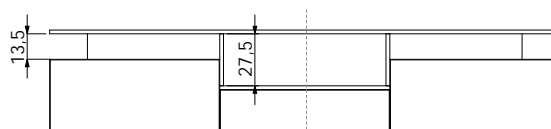

MSH103

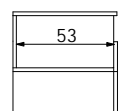

sezione A